

Kelin manne mai d'auke da ruwa shine samfurin karshen muhalli. Wanda Kelin China waterbom epoxy mai kera mai kera shi yayi. Matte texture, yana ba ku madaidaiciyar maɓallin keɓaɓɓen kayan ado, kuma haɗin haɗin yana kama da dacewa da tayal yumbu. Iri iri-iri, bari adonku ya haskaka. Hanyar gidan ruwa mai amfani da ruwa tana sanya samfurin ya zama muhalli. Sand sandar kasa da aka zana a babban zafin jiki yana sa launi ya zama na halitta da kyau kuma ba ya shudewa. Za" a iya amfani da samfurin mafi kyau a cikin d'akunan tayal yumbu, dutse, gilashi, tayal mosaic akan bango ko gari a bandaki, kicin, d'akin kwana da sauransu. Samfurin ne aka fi so a cikin adon iyali, yana kara ion oxygen mara kyau don tsarkake iska. Ostiraliya haɗin haɗin gwiwa da samfuran ci gaba don haɓaka aiki mafi kyau, kuma ta hanyar Kwalejin Kwalejin Kimiyya ta China dabarun kula da ingancin ingancin, don sa samfuran su zama masu inganci.



**Iri launuka don zaɓin ku. Hakanan samar da launuka na al"ada.**



**Bayar da Maganin Tazarar Room Duka**

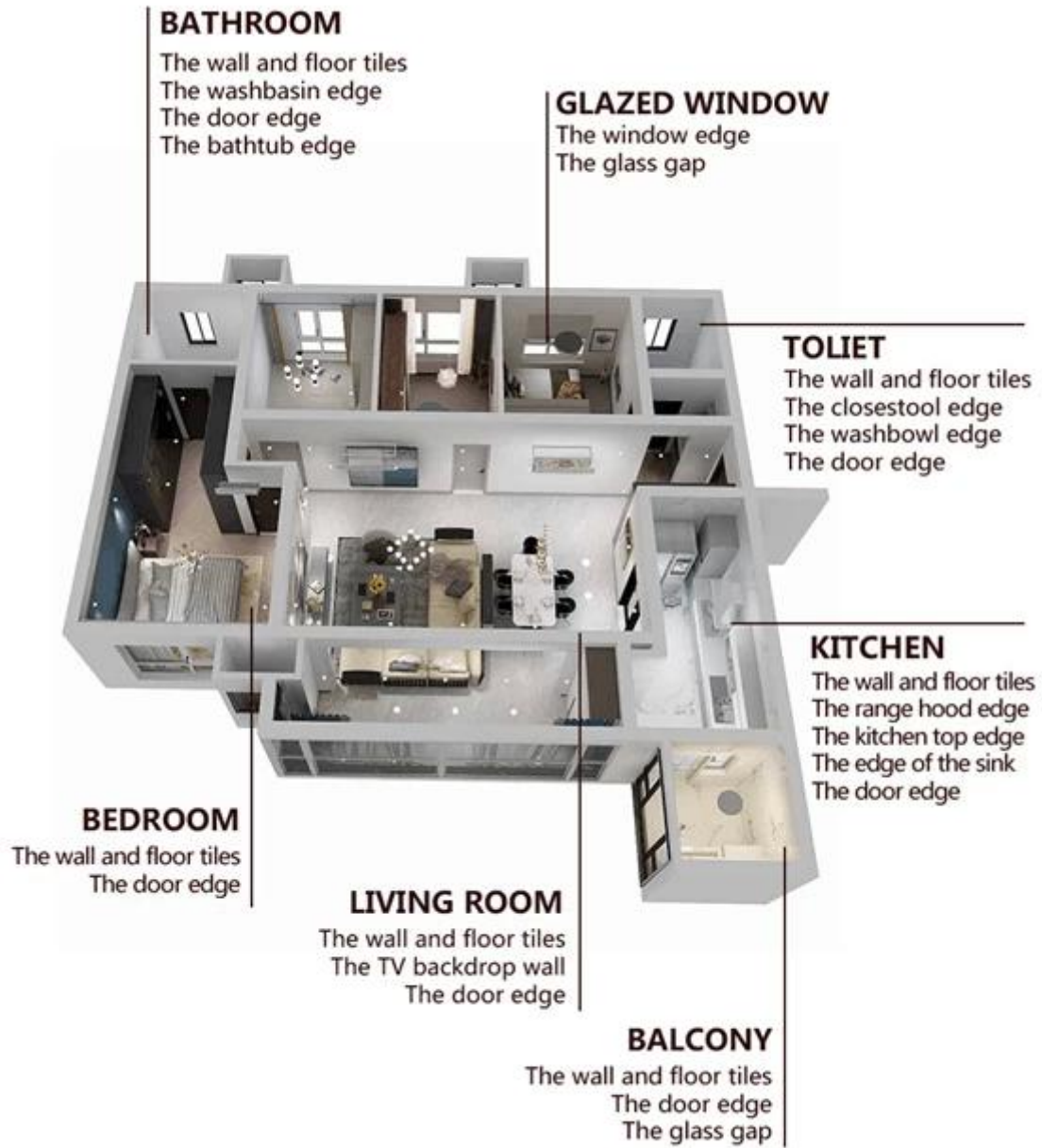

**Takaitaccen Tsarin Tsari**

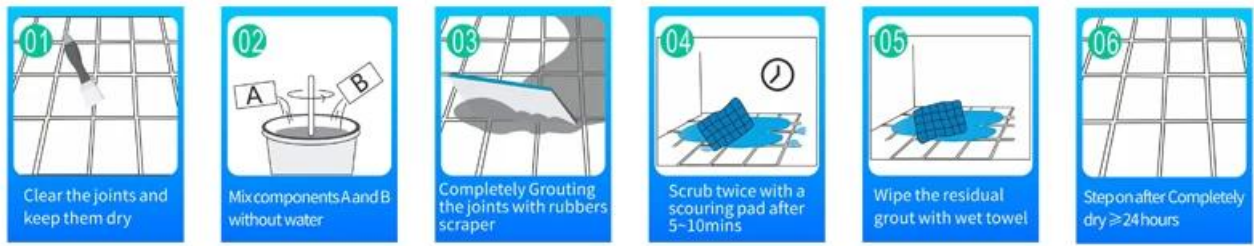

### Kwararren Hadin Gwanin Bugawa



### Amfanin Kamfanin

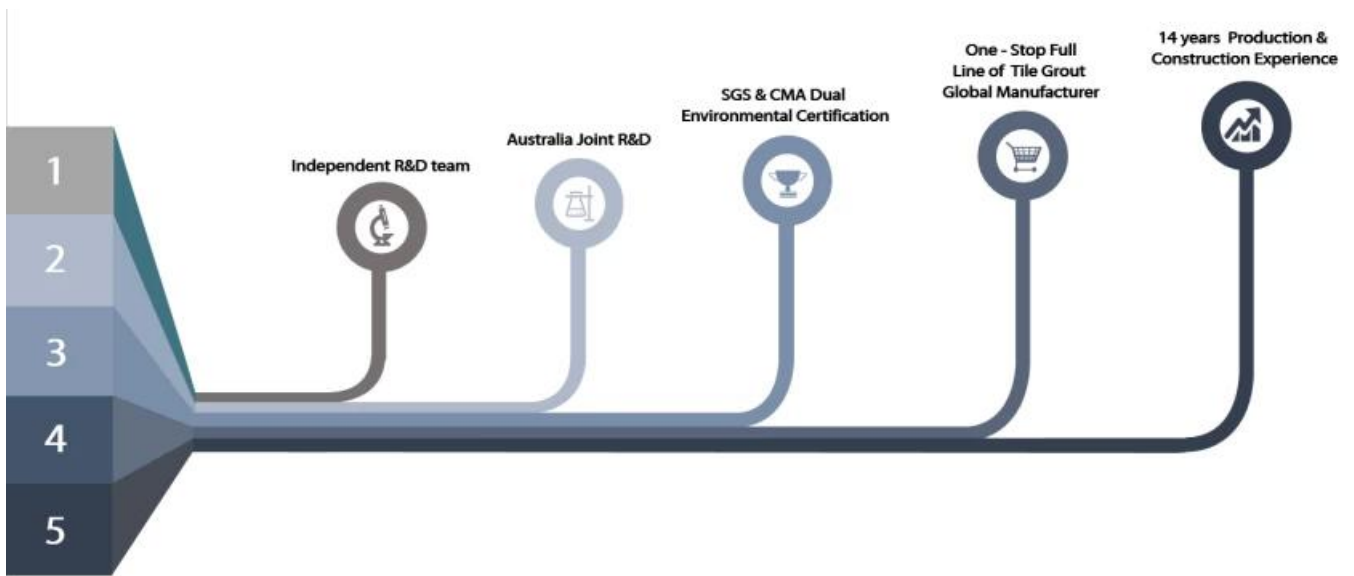

## Bayanin Masana"antu



Layin Na'urar Yin Kuka



Injin gwaji



Layi Production Line



Sanyawa Filing



Ciko Layin Na'ura



Injin da aka saka fim



Hakikanin Kayayyakin Kayan



Hannun jari

## Takardar shaida

