

Kelin polyurea tayal grout sabon samfuri ne wanda yake kifar da kamfanin. Saboda POLYUREA s kyakkyawan juriya-juriya, lalata-juriya, rawaya-juriya, high zazzabi juriya da sauran m yi, ana amfani da ko'ina a cikin soja masana'antu, Aerospace da kuma jiragen ruwa masana'antu. Kayan mu gaba daya polyure ne na asali, za'a iya amfani dashi mafi kyau a dakunan tayal yumbu, dutse, gilashi, tayal mosaic akan bango ko gari na cikin gida & waje. Yana da halaye na musamman na musamman: tabbacin danshi na dindindin, mafi mahalli, warkarwa da sauri, adana aiki kuma baya canza launi, wanda shine babbar fa'idarsa. Bugu da kari, yana karfafawa da sauri, gini da tsafta a rana guda, adana lokaci da farashin ma'aikata. Mafi mahimmanci, ana iya gina shi a cikin farfajiyar gidan ruwa, wanda ke magance matsalar da ba zata iya ginawa ba saboda yanayin yanayi da wasu dalilai. Ostiraliya hadin hadin gwiwa da samfuran ci gaba don haɓaka aiki mafi kyau, kuma ta hanyar Kwalejin Kimiyyar Kimiyya ta China dabarun kula da ingancin kula, don sa kayayyakin "su zama masu inganci. [China polyurea tile grout manufacturer](#), kayayyakinmu suna da kyawawan ingancin iko.



Iri launuka don zaɓin ku. Hakanan samar da launuka na al'ada.

Gray 1#

Gray 2#

Gray 3#

Gray 4#

Gray 5#

Gray 6#

Gray 7#

Gray 8#

Gray 9#

Cement Gray

Dull Gray

Silver Gray

Metal Gray

Luxury Silver

Glacier White

Calaeatta

Pearl Gold

Slate Gray

Terra Brown

Greyish Green

Yellow Gray

Soft Khaki

Yellowish Brown

Olive Brown

Brownness

Dark Brown

Reddish Brown

Rock Bslack



Polyurea Basic Tile Grout Feature

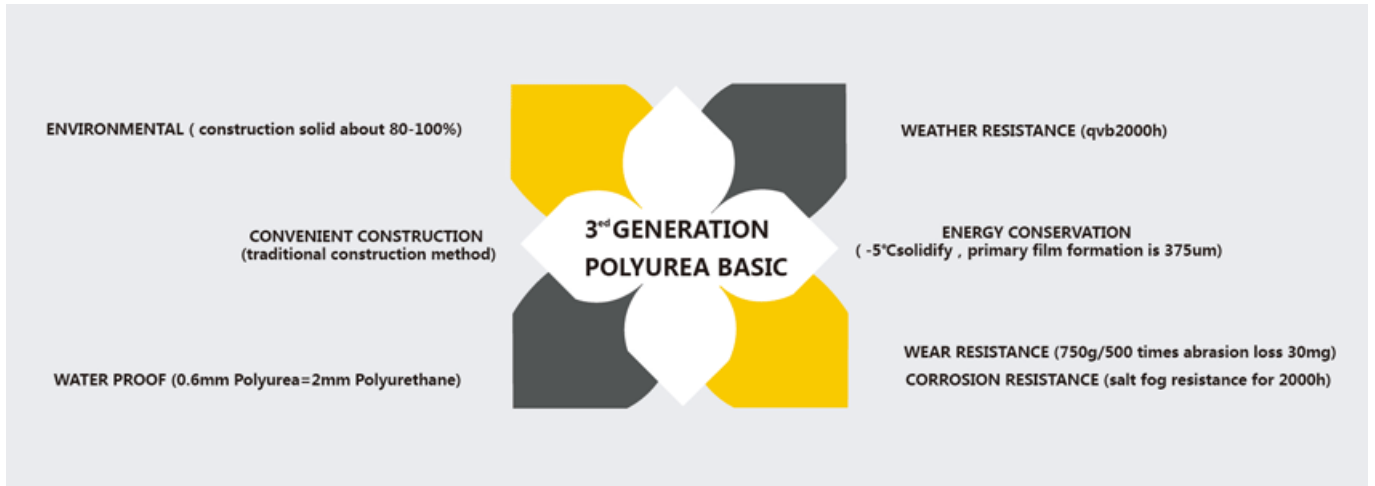

Bayar da Maganin Tazarar Duka Gabafaya

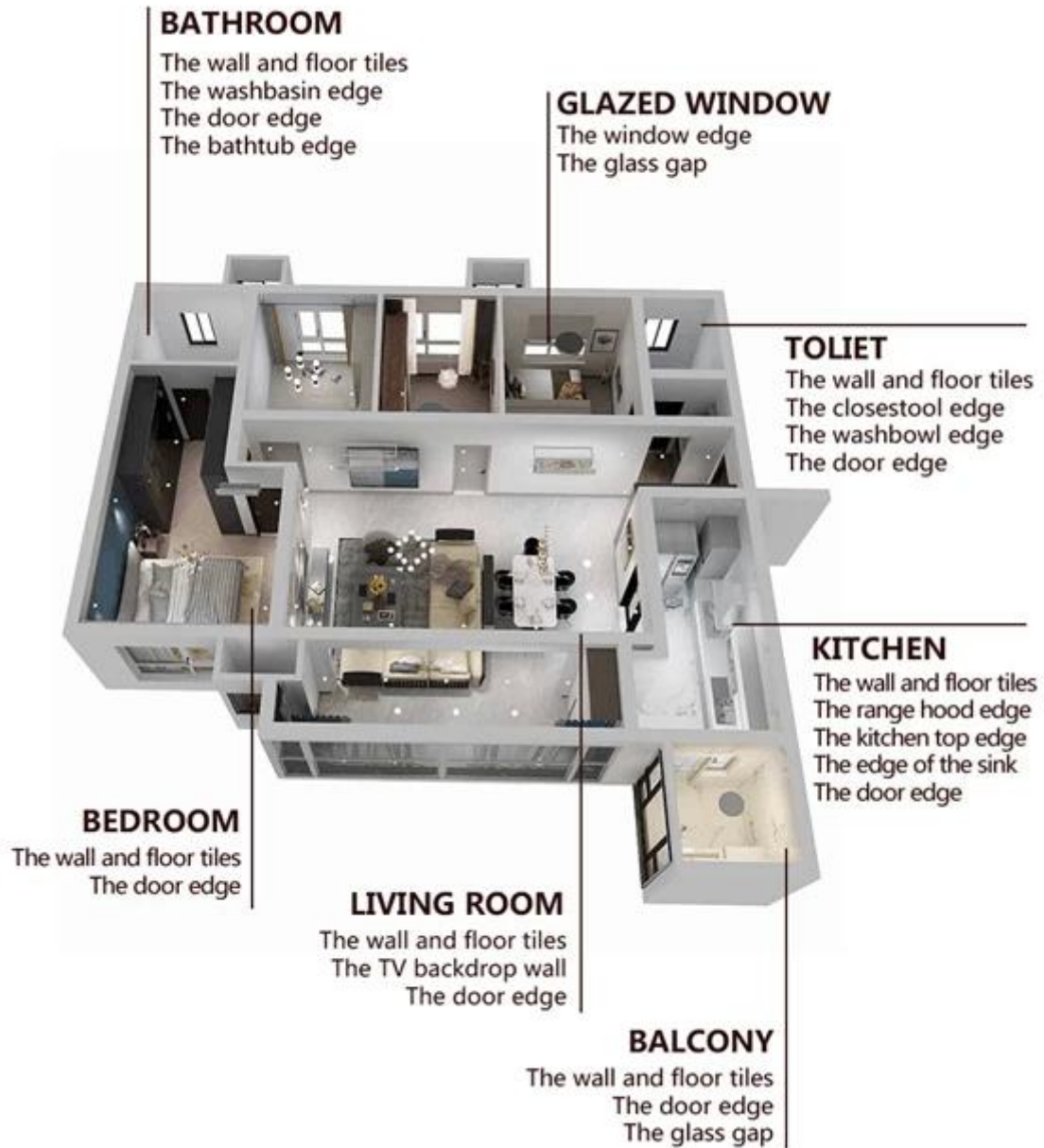

Takaitaccen Tsarin Ginawa

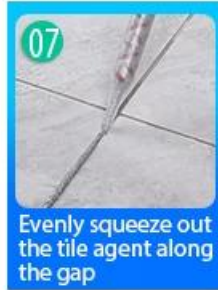

Kwararrun Matakan Hafa Habakawa