

Kelin Waterborne epoxy m adhesive shine babban samfurin muhalli. Matte rubutu, yana samar maka da karamin salon kayan kwalliya na kayan kwalliya, kuma yanayin haɗin gwiwa yana da cikakkiyar dacewa ga tayal din yumbu. Iri na launuka, bari wurin ado na ado. A mafi kyawun hanyar ruwa na ruwa mai saukin amfani da epoxy yana sa samfurin gaba ɗaya muhalli muhalli. Yashi na dabi'a kinshe a kan zafin jiki yana da launi na halitta da kyau kuma baya yin faduwa. Ana iya amfani da samfurin mafi kyau a cikin gidajen tayal, dutse, gilashin mosaic a bango ko gari a cikin gidan wanka, dafa abinci da sauransu. Shine samfurin fifiko a cikin kayan ado na iyali, yana kara eon mara kyau na iskar overgen don tsarkake iska. Australia hadin gwiwar cigaba da kayayyakin ci gaba don yin kyakkyawan aiki, kuma ta hanyar kwarewar kasar Sin game da ingancin ingancin kasar Sin da ke dabarar ingattakun manufar Sin, don samar da ingantattun kayayyaki. Idan kun chioce [Fasahar Tile](#), don Allah zaɓi Kelin.



Irin launuka na launuka don zaɓinku. Hakanan samar da launuka na musamman.





Brief aikin gini

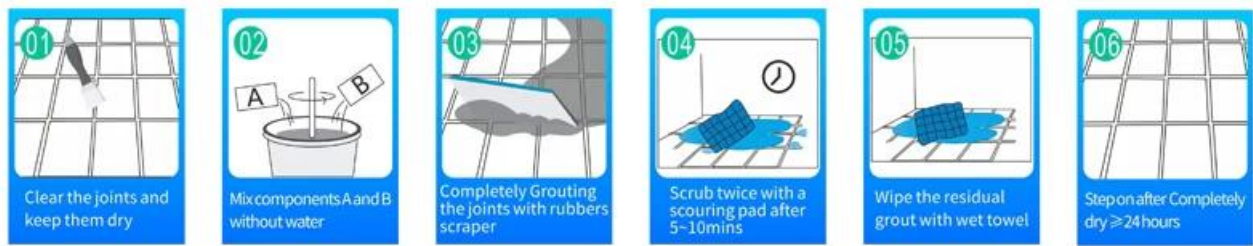

Kayan aiki mai dorewa



Amfani da Kamfanin

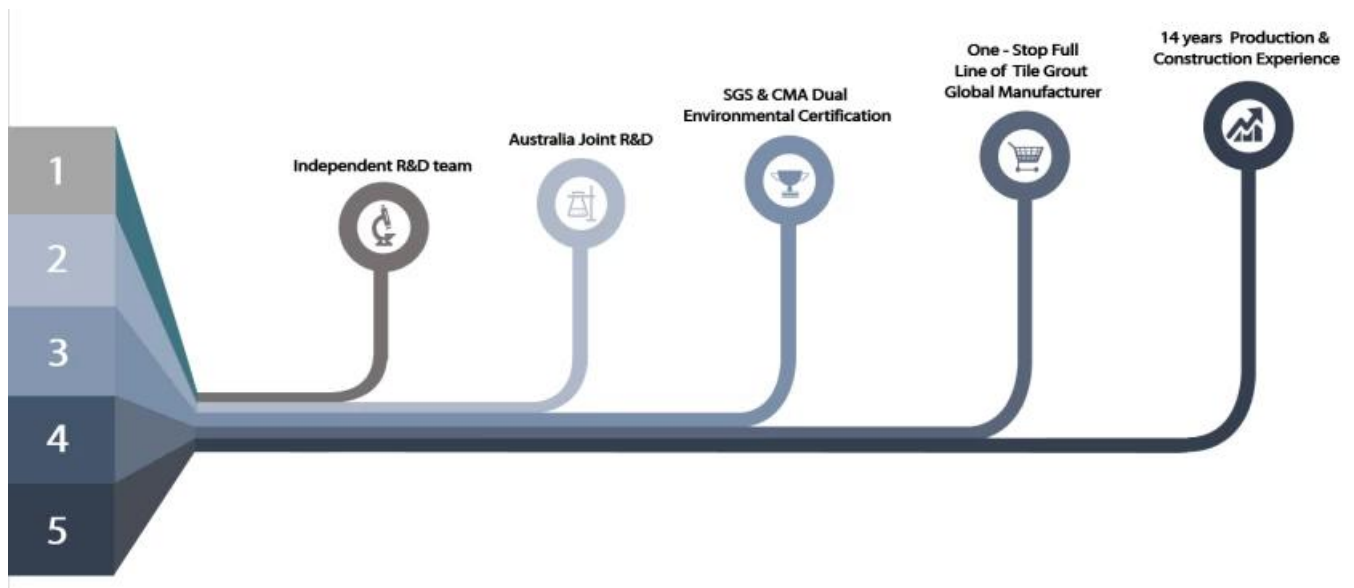

Fastocin masana\anta



Layin injin cream



Injin gwaji



Bayanin sarrafa batutuwa



Sanyi mai sanyaya



Cika layin injin



Mashin mai rufi



Kayan Kayan Kayan Gaskiya



Jari

Ba da takardar shaida

